

Background

The **AYO™ Full-Face Mask (FFM)** lens-piece can be configured for **Loose-Fitting (LF)** or **Double-Seal (DS)** configuration using different component sets.

This Guide will illustrate the steps to correctly convert from a **Full-Face Mask Loose-Fitting (FFM-LF)** (1) into **Full-Face Mask Double-Seal (FFM-DS)** (2) assembly.

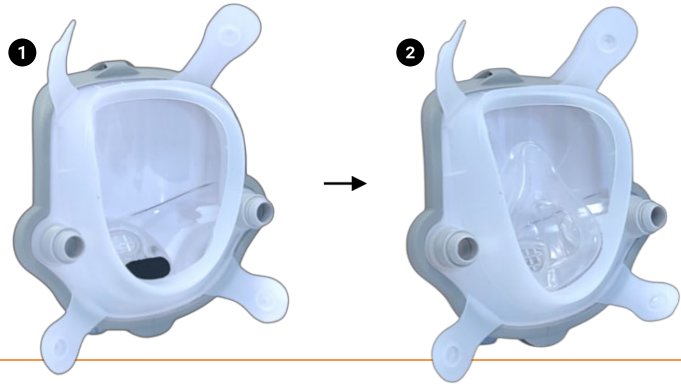

The additional parts needed to complete the conversion should come pre-assembled into an *Inner Mask Assembly* (below). Other parts used for the conversion are interchangeable between **LF** and **DS** configurations.



1. Unfasten the *threaded plugs* (1) from either side of the **FFM-LF** and put them in a safe place; they will be required later in this Guide.
2. Pop out the exposed *threaded connectors* (2) from the silicone cushion; they will not be used again in this Guide and can be put aside.

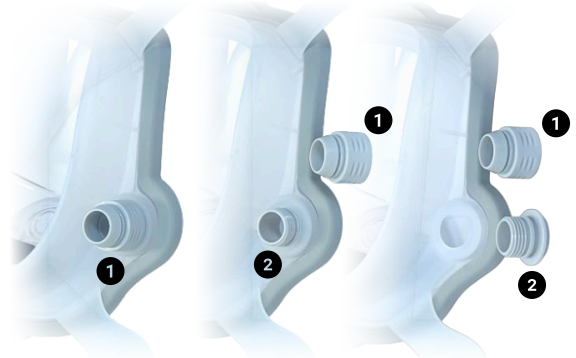

3. Using an M2.5 Allen key, unfasten the two bolts (1) in the mouthpiece module and set aside safely.
4. Remove the *module cover* (2) and *membrane seat* (3) and set aside safely. Note the *silicone gasket* (4) that rests around the *membrane seat*; handle this with care, it is a function-critical sealing component.
5. Remove the chin-support *front module base* (5). This will not be used again for this Guide.



6. Manoeuvre the *Inner Mask Set* into the **FFM lens-piece** and push the *threaded ends* (1) all the way through the silicone openings, ensuring the threads are completely exposed.

Note the stepped profile of the *adaptor plate* edge (2); this serves to properly seat and centre the *Inner Mask Set* within the mouthpiece opening. Observe, also, that the *adaptor plate* does not rest evenly on the opening lip; this gap (3) must be physically held shut in later steps.

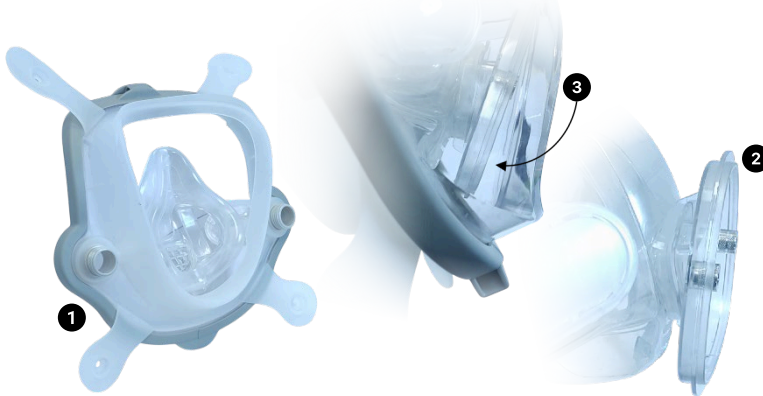

9. Press down on the *Inner Mask Set* from behind to seal the gap from Step 6. While the gap is compressed shut and the *adaptor plate* rests flush (1) along the *lens-piece* ledge, refasten the bolts (2) from Step 3.

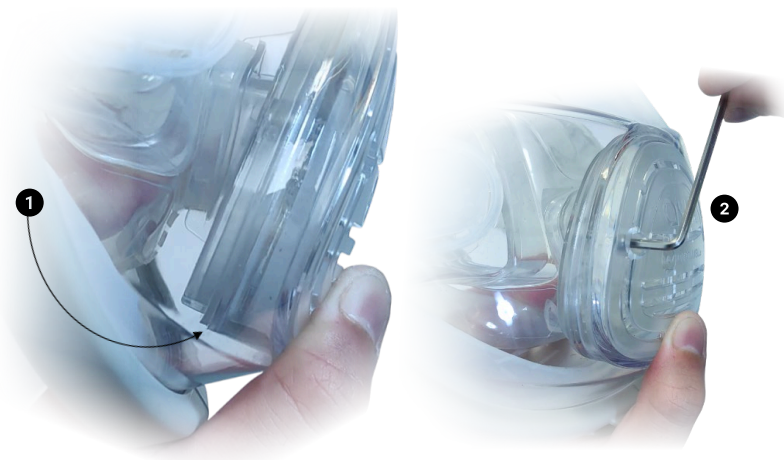

7. Plop the *membrane seat* (1) back into the front of the mouthpiece opening, ensuring that the *silicone gasket* is flush.
8. Drop the module cover (2) over the membrane seat.

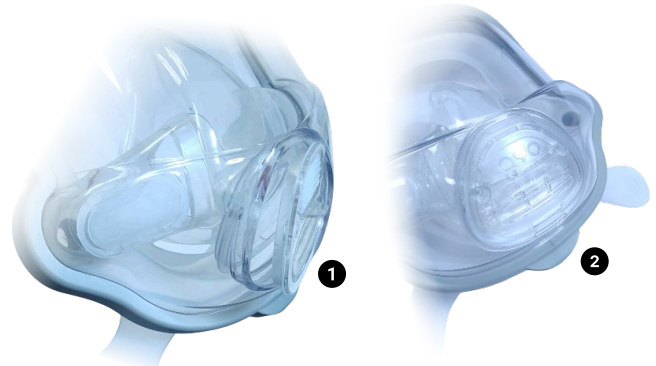

10. Refasten the *threaded plugs* (1) from Step 1.

Your **Full-Face Mask Double-Seal (FFM-DS)** mask assembly is now complete.



You will be left with a *front module base* (1) and two *threaded connectors* (2). These comprise the *DS-to-LF Changeover Kit* and should be put into safe storage for future conversion back to **FFM-LF** configuration.

